

MONUMENT²⁹

ARCHITECTURE | DESIGN

AUG 14 95 US\$12.95 CAN\$16.95 UK£4.95 SINGLE ONLINE GST COVER PHOTOGRAPHY BY HARRY WATERMAN



619

THE FUTURE CITY
by Peter Oberlander,.....
AlsoCAN/Multiplicity,
Peter Droege, Mark Gerada,
Chris Johnson, Serge Zaleski

On tour with Virginia Kerridge

PARIS IS BURNING:
Re-defining French graphics

PLUS:
Berlin
John Pawson in Hong Kong
Renzo Piano in New Caledonia

PRINT POST APPROVED PP 233867 00013



FUTURE CITY

CHANGE NOW SEEMS TO HAPPEN AT AN EXPONENTIALLY INCREASING RATE AND NOWHERE IS THIS MORE APPARENT THAN IN CITIES. AS INDIVIDUALS FIND IT MORE AND MORE DIFFICULT TO IMAGINE A FUTURE FOR THEMSELVES IN AN AGE OF INSTITUTIONALISED UNCERTAINTY, WHAT ABOUT THE FUTURE OF THE CITIES MOST OF US LIVE IN? IS IT POSSIBLE TO IMAGINE THE CITY OF THE FUTURE?

MONUMENT CHALLENGED A TEAM OF ARCHITECTS, PLANNERS, WRITERS, DESIGNERS AND ILLUSTRATORS TO REFLECT ON THE IMPERATIVES OF THE FUTURE CITY AND TO PICTURE WHAT IT MIGHT LOOK LIKE.

*BELINEATION
GRAPHIX ©*

You are an urban professional in the year 2021. The nature of work requires you to move wherever transient employment opportunities arise. But fear not, urban nomad of the future. The Slinky house comes with you. It is compactable and transportable. It can be positioned in under utilised, public spaces: straddling lanes, appropriating rooftops, sited on railway embankments, sometimes parasitic on the city infrastructure, sometimes subsisting in isolated environments.

The Slinky house comes as a system, customisable to your requirements. The basic frame consists of waffle framed elliptical floor plates, their cells available for insertion of customisable parts to fit out the house. The slinky tubes form a helical structure between the floor plates. In compressed form the floor plates and coiled tubes lie stacked and can be loaded onto the back of a truck, or into a cargo hold. At the new site the coils are expanded upwards, forming the house. All the comforts of home for the new urban nomad.

SLINKY HOUSE

THE WINNING SCHEME IN THE MUSEUM OF VICTORIA'S HOME OF THE FUTURE ARCHITECTURAL COMPETITION WAS THE SLINKY HOUSE BY THE YOUNG MELBOURNE ARCHITECTURE PRACTICE ALSO CAN / MULTIPLICITY. HERE THEY GIVE US A GLIMPSE INTO HOW THEY WOULD LIKE US TO LIVE IN THE FUTURE.

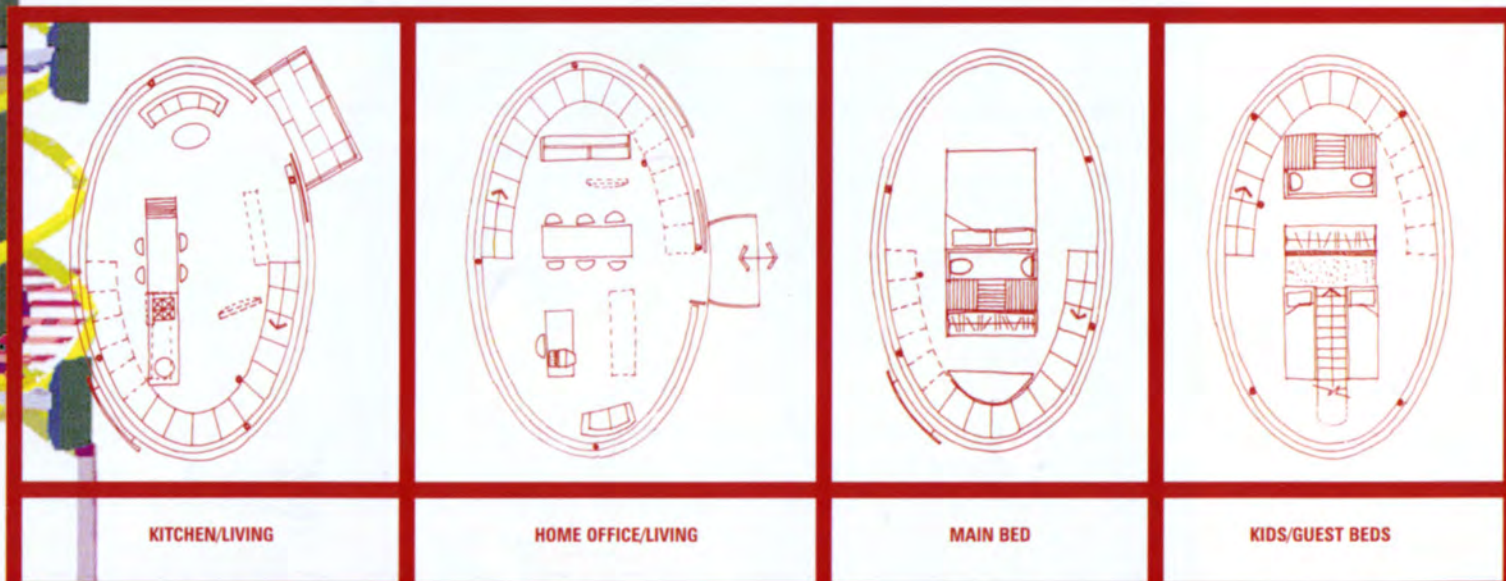
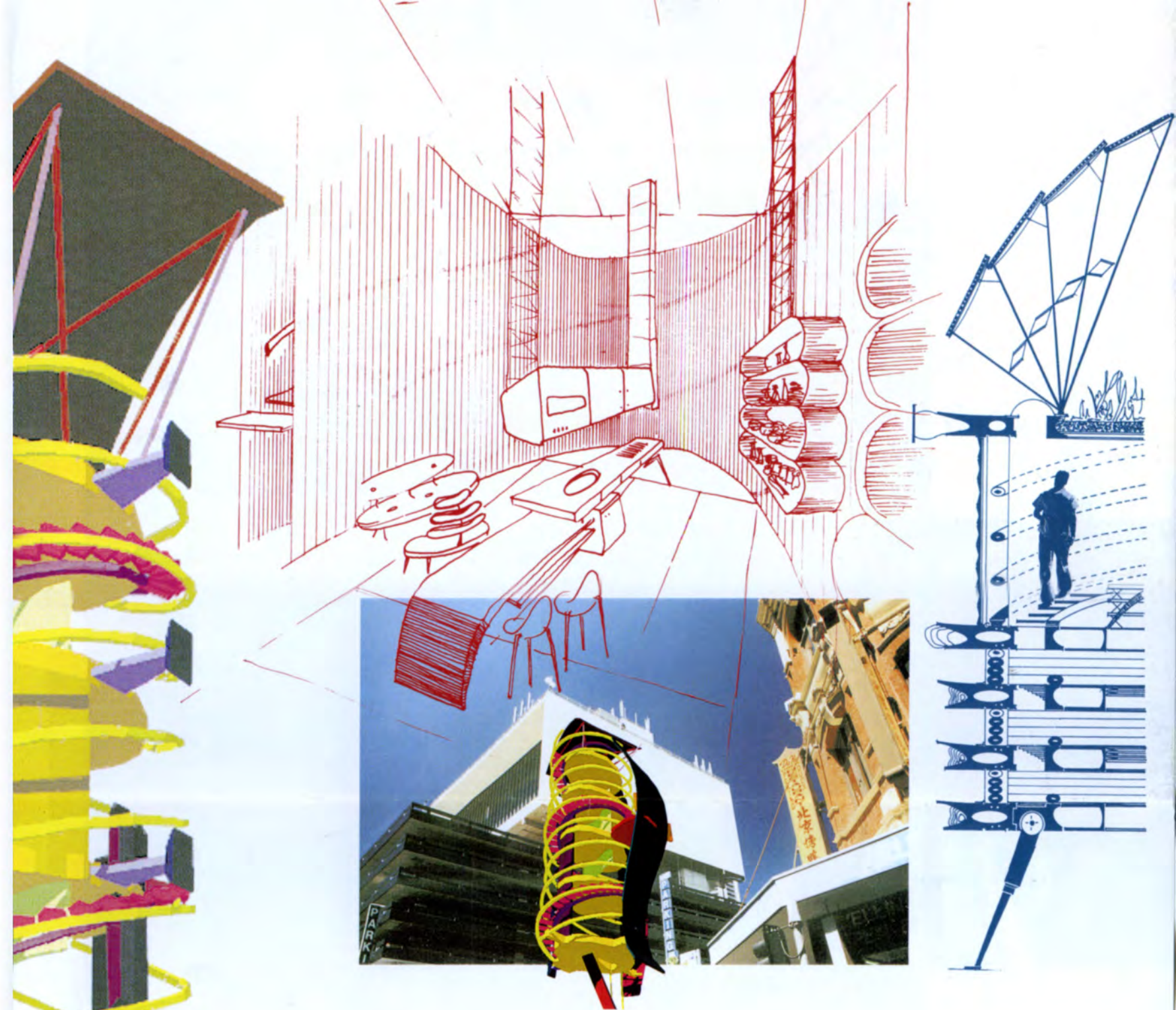
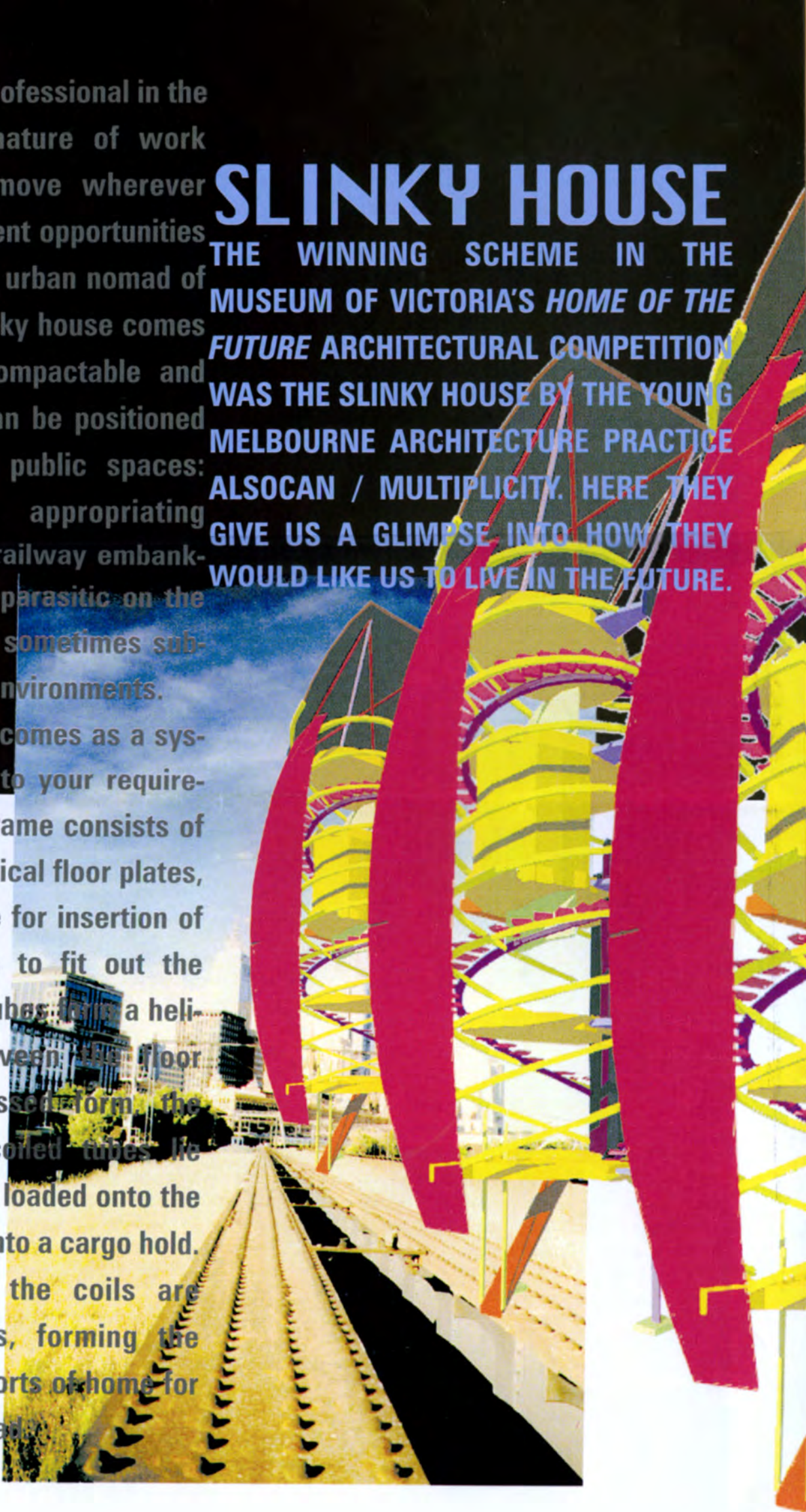

EXAMPLES OF FLOOR USES — MANY CONFIGURATIONS

BY ALSO CAN ARCHITECTS

> David Beynon, Jane McDougall & Andrew Morant - AlsoCAN Architects
 > Tim O'Sullivan & Sioux Clark - Multiplicity
 > Michael Pablo (assistance with graphics) - Isolated Enterprise
 > Museum Victoria